

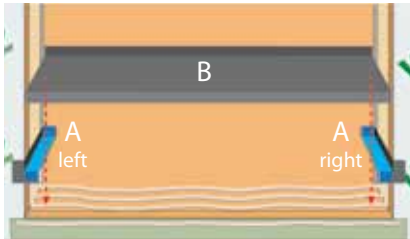

SunClad Doors - Sill Pan Installation Instructions

Avoiding Call Backs Tip! *Installing a Sill Pan, prior to installing a door, can help prevent damage caused by water infiltration from a variety of potential sources.*



Install The Sill Pan

Door sill pan contains 3 parts:
A End Caps (2 - left & right)
B Sill pan (1)

Note: The Sill Pan Must Be Installed On A Level Surface.

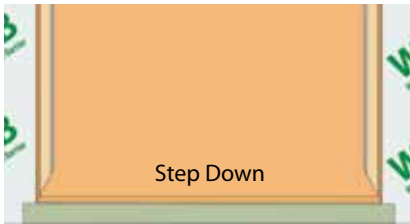

Determine Sill Type Step Down or Flush To The Floor

Step Down - If the installation has an exterior that steps down from the interior floor, the sill pan and end caps are ready to use as packaged.

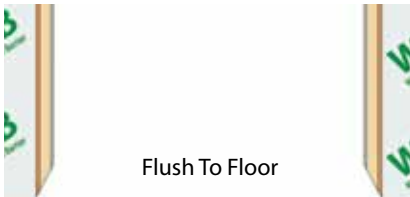

Flush To Floor - If the installation is flush to the floor, the sill pan and end caps must have the bottom Step Down lip removed.

If the installation is on a **Step Down**, proceed to **next step**.

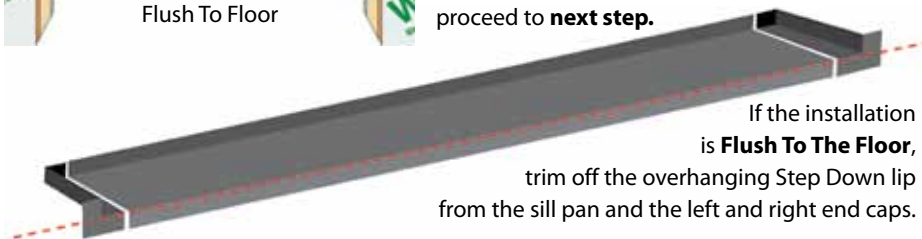

If the installation is **Flush To The Floor**, trim off the overhanging Step Down lip from the sill pan and the left and right end caps.

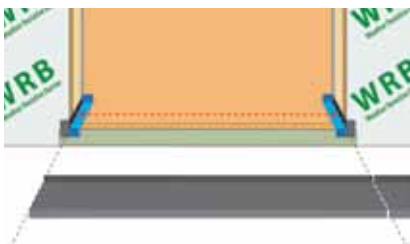

Cut The Sill Pan To Fit Width

Place the left and right sill pan **End Caps** tightly in each corner of the rough opening and measure the distance between to determine the cut length for the sill pan. Cut the sill pan to the measured length. Before moving to the next step, remove both end caps.



Apply Sealant To Sill Area

Using AAMA 808 compliant polyurethane sealant, apply three 3/8" beads of sealant along the entire length of the sill floor AND continue 2" up each side of the opening. For installation on a **Step Down**, also apply one 3/8" bead of the sealant to the outer edge of the step down (or the backside of the overhanging lip of the pan and end caps).



Set End Caps

Press the left and right end caps firmly into the sealant. Nail each end cap to the rough opening using the nail slot provided. Remove the adhesive tape protective cover from each end cap.

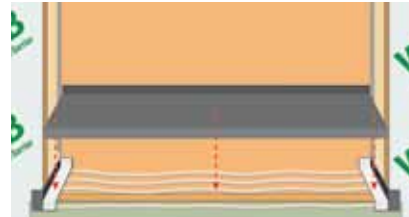

Set Sill Pan

Firmly press the sill pan into the sealant.



Apply Sealant

Apply one 3/8" bead of sealant in the (1) left and (2) right corners where the sill pan fits against the end caps.



Just before installing the door, apply one 3/8" continuous bead of sealant, from end to end, along the back vertical lip of the sill pan.

For flush to the floor installations, also apply one 3/8" bead of sealant to where the front outer edge of the sill pan meets the floor.